

# Wago pluggbar kabling for HVAC installasjoner "Modbus" Siemens

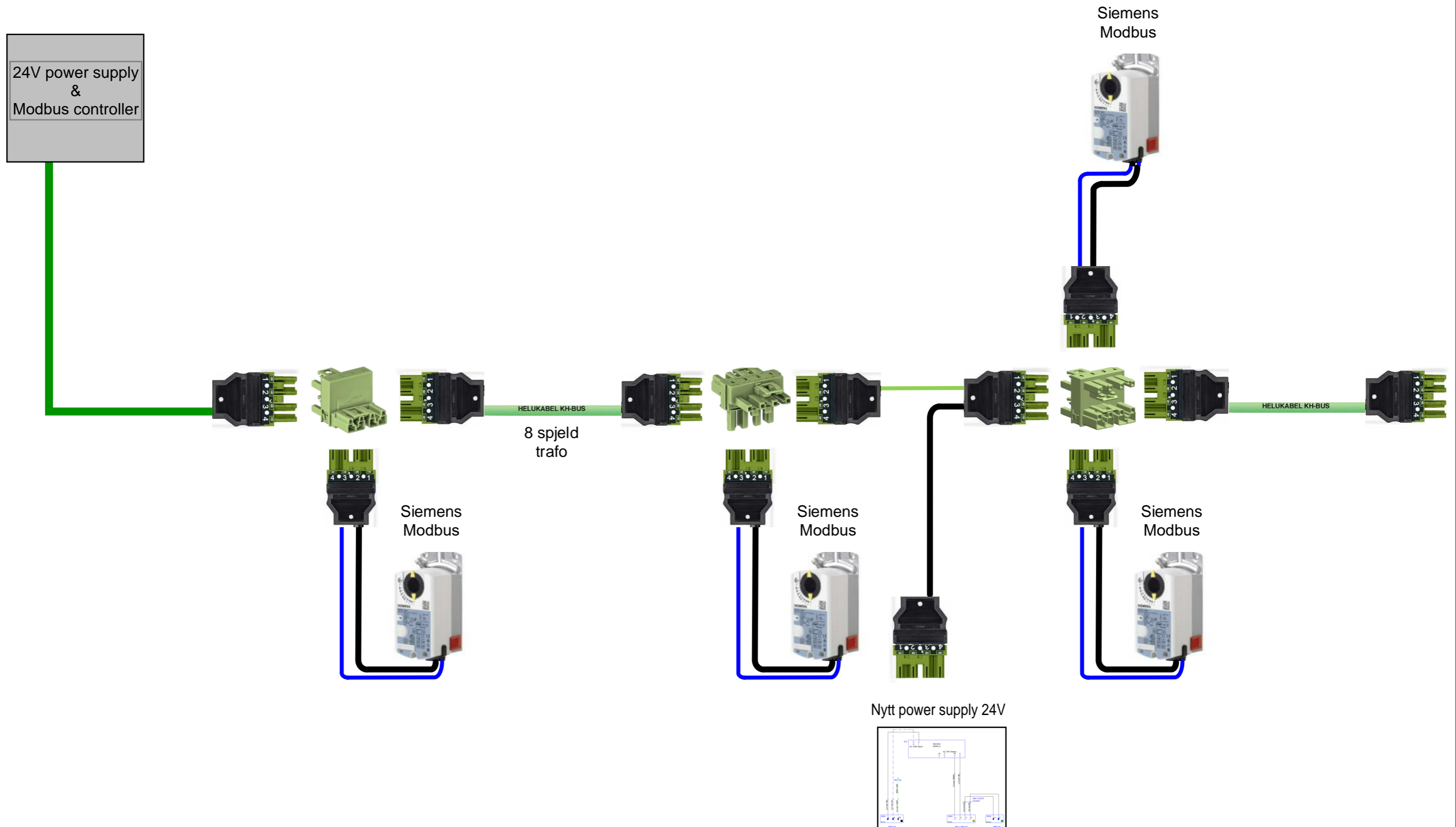

Anderungen	D		DATUM	NAME
C		GEZEICHNET	25.11.2019	Rosenke
B		BEARBEITET		
A		GEPRÜFT		

Modbus



ZEICHNUNGSNUMMER  
ARTIKELNUMMER

# Wago pluggbar kabling for HVAC installasjoner "Modbus" Siemens

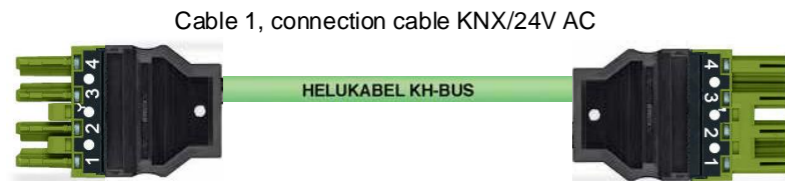

Cable 1, connection cable KNX/24V AC

**Wire assignment:**

- 1 / G0 / - = blue
  - 2 / G / + = red
  - 3 / KNX+ = pink
  - 4 / KNX- = grey
- Cut: yellow, green  
Raw cable: Helukabel KH-BUS 2x1,5mm<sup>2</sup> + 2x2x0,6mm<sup>2</sup> FRNC (No. 81447)

**Item No.**

3m	0771-0099/K000-0357	60417441
5m	0771-0099/K000-0358	60417443
8m	0771-0099/K000-0359	60417445
10m	0771-0099/K000-0360	60417447
15m	0771-0099/K000-0361	60417448

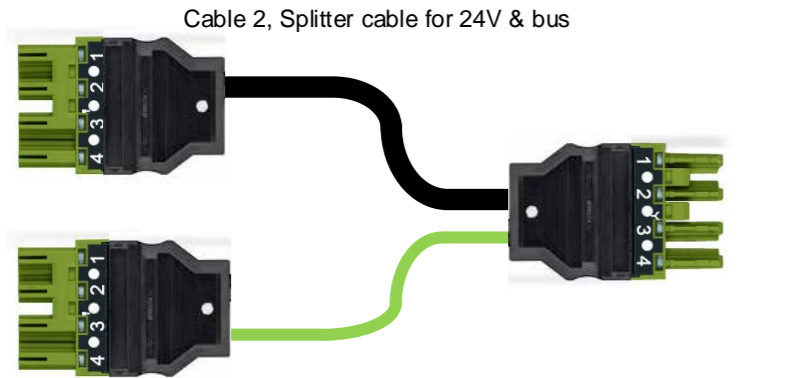

Cable 2, Splitter cable for 24V & bus

**Wire assignment:**

- 1 / G0 / - = blue
  - 2 / G / + = brown
  - 3 / KNX+ = red
  - 4 / KNX- = black
- Raw cable:  
H05Z1Z1-F 2x1mm<sup>2</sup>  
BUS EIB Combi 1x2x0,8mm<sup>2</sup>, halogen free

**Item No.**

1m	0771-0099/K000-0371	60420185
2m	0771-0099/K000-0372	60420186

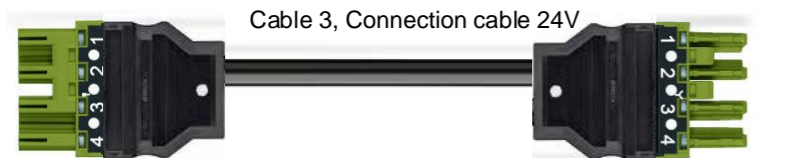

Cable 3, Connection cable 24V

**Wire assignment:**

- 1 / G0 / - = blue
  - 2 / G / + = brown
  - 3 / = not connected
  - 4 / = not connected
- Raw cable:  
Raw cable: H05Z1Z1-F 2x1,5mm<sup>2</sup>, halogen free

**Item No.**

2m	0771-0099/K000-0370	60420184
----	---------------------	----------

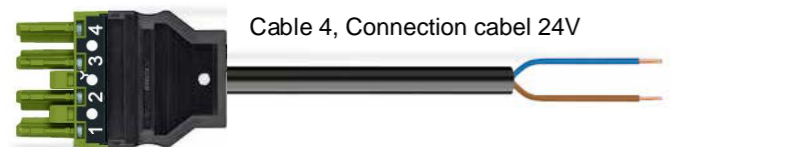

Cable 4, Connection cable 24V

**Wire assignment:**

- 1 / G0 = blue
  - 2 / G+ = brown
  - 3 = not connected
  - 4 = not connected
- Raw cable: H05Z1Z1-F 2x1,5mm<sup>2</sup>, halogen free

**Item No.**

1m	0771-0099/K000-xxxx	
2m	0771-0099/K000-xxxx	

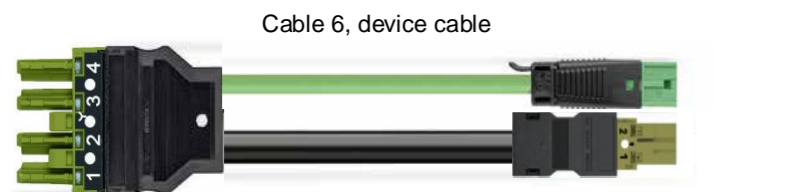

Cable 6, device cable

**Wire assignment:**

- 1 / G0 / - = blue
  - 2 / G / + = brown
  - 3 / KNX+ = red
  - 4 / KNX- = black
- Raw cable:  
H05Z1Z1-F 2x1mm<sup>2</sup>  
BUS EIB Combi 1x2x0,8mm<sup>2</sup>, halogen free

**Item No.**

1m	0771-0099/K000-0369	60420183
----	---------------------	----------

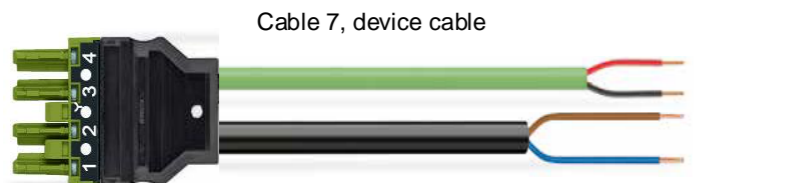

Cable 7, device cable

**Wire assignment:**

- 1 / G0 / - = blue
  - 2 / G / + = brown
  - 3 / KNX+ = red
  - 4 / KNX- = black
- Raw cable:  
H05Z1Z1-F 2x1mm<sup>2</sup>  
BUS EIB Combi 1x2x0,8mm<sup>2</sup>, halogen free

**Item No.**

1m	0771-0099/K000-0368	60420187
----	---------------------	----------

Anderungen	D	DATUM	NAME
C		25.11.2019	Rosenke
B			
A			

Modbus



ZEICHNUNGSNUMMER
ARTIKELNUMMER

# Wago pluggbar kabling for HVAC installasjoner

## "Modbus" Siemens

Cable 8, cable KNX / bus tap off device cable



**Wire assignment:**

- 1 / G0 / - = not connected
  - 2 / G / + = not connected
  - 3 / KNX+ = red
  - 4 / KNX- = black
- Raw cable:  
 BUS EIB Combi 1x2x0,8mm<sup>2</sup>, halogen free

**Item No.**

- 1m 0771-0099/K000-0373 60420438
- 4m 0771-0099/K000-0374 60420439



770-101



770-1732 1Inn 2Ut

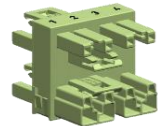

770-1735 1Inn 3Ut



770-1782 1Inn 2Ut



770-274 plugg/Hann Spjeld



770-264 sokkel/Hunn Tilførsel



Strekklasterhus for plugg/sokkel

770-504 (Ø 9-13mm)  
 770-504/023-000 (Ø 5-9mm)

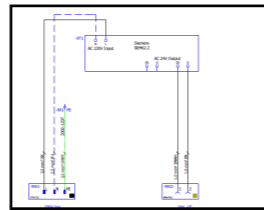
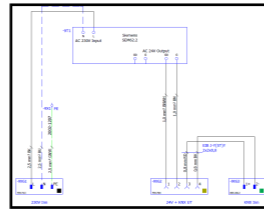

**For Cabel 4 (X) byttes ut med lengde. KNX Accessories**



893-1606 KNX 1inn 2 ut



51191777 KNX 1inn 3 ut

893-8992/033-X06 (X=meter)



**24V Accessories**



770-1702 1inn 2 ut grønn



770-1752 1inn 2 ut



770-1705 1inn 3 ut grønn

770-8992/006-X05 (X=meter)



Änderungen	D		DATUM	NAME
	C		25.11.2019	Rosenke
	B		GEZEICHNET	
	A		BEARBEITET	